



Skokie 847-677-2010

Glenview 847-657-9020

Wheeling 847-537-2255

## Gas Powered Pressure Washer

### Setup:

1. This unit should only be placed on a level surface to ensure proper lubrication for the engine and water pump while operating. NEVER spray water directly on the unit!
2. Do not place unit in an area:
  - A. with insufficient ventilation
  - B. where there is evidence of oil or gas leaks
  - C. where flammable gas vapors may be present
3. Be certain to block the wheels to prevent the unit from moving while operating.
4. Do not allow the unit to be exposed to rain, snow or freezing temperatures. If any part of the unit becomes frozen, excessive pressure may build up in the unit which could cause it to burst resulting in possible serious injury to the operator or bystanders.
5. Before initial use, ensure the oil dipstick is inserted into the pump. Because of varying shipping requirements, the pump may need to be shipped with an oil travel plug instead of the dipstick in the pump. If your pump has been shipped with an oil travel plug, you will need to remove it and replace the plug with the oil dipstick provided with the unit.
6. Once properly installed, check the oil sight glass on the pump crankcase. Make certain the oil level is in the center of the sight glass before each use. If the level appears to be low, use Mi-T-M pump oil #AW-4085-00\_6. **DO NOT OVERFILL!**

### Engine fuel tank:

1. Locate the Safety Decals on your unit and heed their warnings.
2. A minimum of 86 octane fuel is recommended for use with this unit. **DO NOT MIX OIL WITH GASOLINE.**
3. Purchase fuel in quantities that may be used within 30 days. Use of clean, fresh lead free gasoline is recommended. Leaded gasoline may be used if lead-free is unavailable. **DO NOT** use gasoline containing methanol or alcohol.
4. Check the engine oil level before starting the engine.
5. Occasional carburetor and choke adjustments will be necessary for the engine.

### Installation & Preparation

#### Nozzle review:

Various nozzles may be quick-connected into the end of the wand to change the spray pattern or use the detergent feature. When using Quick Connects (Q.C.), be certain the connection is securely locked. If not, the high pressure water may shoot the nozzle from the wand, causing severe injury or serious damage. To determine spray fan, refer to the actual number stamped on the nozzle. The first two digits indicate the spray fan in degrees, i.e.; 00=0°, 15=15°, 25=25°, 6540°=detergent/low pressure.

1. **The 0° nozzle (red):** This is a blasting nozzle. It delivers a very concentrated stream of water. Be cautious when using the straight narrow stream. It is not recommended for use on painted or wood surfaces, or items attached with adhesive backings. Uses: Removing weeds from sidewalk cracks, stubborn stains from concrete, masonry, aluminum and steel, caked mud from equipment, and cleaning lawn mower undersides.
2. **The 15° nozzle (yellow):** This is a chiseling nozzle. The spray should be directed at a 45° angle to the surface and used like a scraper to remove paint, grease and dirt. Uses: Surface preparation (removing mildew stains and paint chips).

**3. The 25° nozzle (green):** This is a flushing nozzle. This pattern is best suited for flushing dirt, mud, and grime. Uses: Wet sweeping leaves from walks, curbs and driveways, cleaning stable floors, washing swimming pool bottoms, degreasing engines.

**4. The 65° nozzle (black):** This is a low pressure detergent application nozzle. This broad spray pattern distributes solution over vast areas under low pressure. Uses: Detergent application, misting or rinsing.

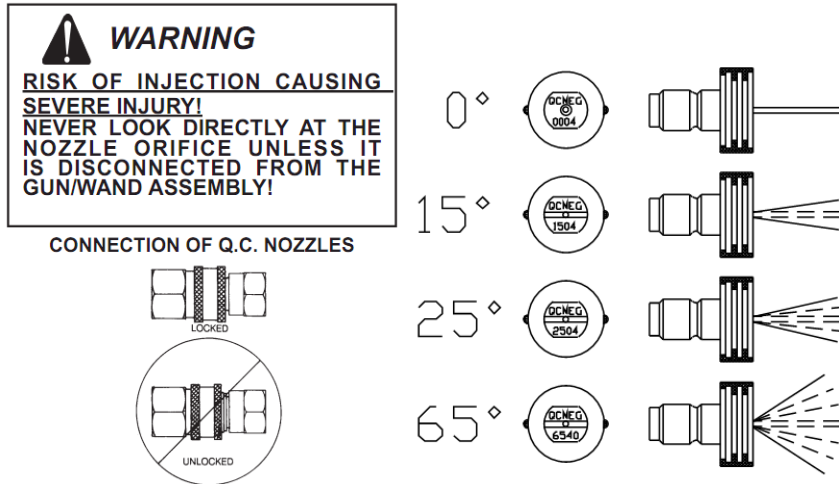

**Nozzle connection:**

1. Be certain the trigger gun is locked in the "OFF" position. See *WARNING*.
2. The nozzle assembly should be disconnected from the gun assembly at this time. Retract the locking ring on the quick-connect fitting to remove the nozzle.

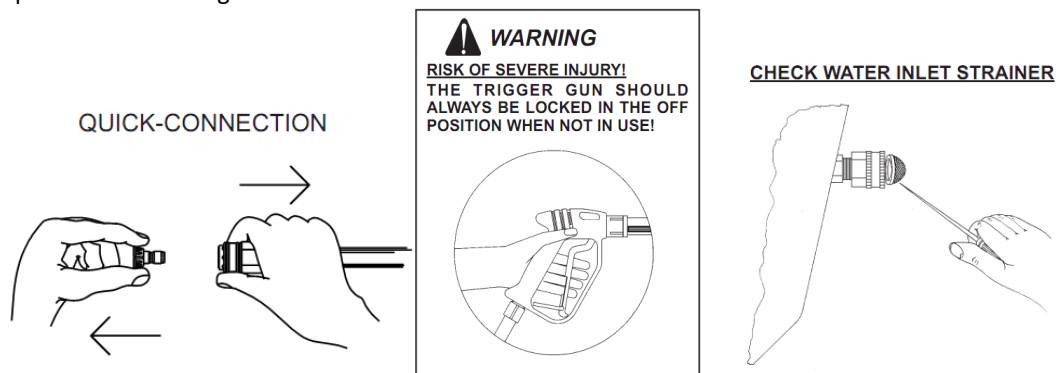

**Water supply:**

1. Select a water supply hose which is a quality grade of garden hose measuring at least 3/4" ID and no longer than 50 feet.
2. Check the water inlet strainer to ensure it is clean and free of any obstructions. Periodic cleaning of the water strainer will help prevent pump problems. As a strainer becomes obstructed, it restricts proper flow of water to the pump. This can result in cavitations which will cause premature failure of pump packing's. Using a screw driver, remove the screen; clean or replace with Mi-T-M #\_9-000\_ if necessary.
3. Connect the hoses:
  - a. Connect one end of the water supply hose to the water inlet of the unit.
  - b. Connect the other end of the hose to your pressurized water supply.

**NOTE:** Do not use a non-pressurized water supply (i.e. from a pond or well) with this unit.

  - c. Quick-connect the high pressure discharge hose to the water outlet of the unit.
4. Follow the incoming water requirements listed below:
  - a. Water pressure must be a minimum of 20 pounds per square inch (PSI) and a maximum of \_25 PSI. (A typical outdoor faucet will generally supply this PSI if turned completely "ON".)

- b. Incoming GPM must be approximately one gallon more than the outgoing GPM stated on the pressure washer nameplate. (You can check GPM by timing how long it takes to fill a 5 gallon container.)
- c. Incoming water temperature must not exceed  $_{25^{\circ}\text{F}}$ . Excessive pump damage may result if the water temperature exceeds this acceptable level.

5. Never allow the unit to operate without the incoming water line attached and the water supply completely turned on.

## **Operating instructions**

### **Priming the pump:**

1. It is essential to prime the pump on initial start-up and each time the water supply is disconnected from the unit after initial use.
2. Lay the high pressure hose out to remove any loops. Water flow will tighten the hose, creating tight loops if the hose is not straight.
3. Securely connect the gun assembly to the high pressure hose. **NOTE:** The nozzle assembly should NOT be connected to the gun assembly at this time.
4. With the trigger gun locked in the "OFF" position, turn the water supply completely on. Pointing the gun in a safe direction, unlock the trigger gun and squeeze the trigger.
5. Low pressure water will begin flowing from the hose/gun assembly. This allows the unit to prime and purge any air from the system. The unit is primed when water flow is uninterrupted by air.
6. Once the unit is primed, release the trigger and lock the gun in the "OFF" position. Securely connect the nozzle assembly.
7. Once the engine has started, perform the following procedures with the gun open:
  - a. Inspect for system water leaks, oil leaks and fuel leaks. If a fuel leak is found, TURN UNIT OFF IMMEDIATELY! Be sure that all damaged parts are replaced and that the mechanical problems are corrected prior to operation of the unit. If you require service, contact Mi-T-M Customer Service.
  - b. Inspect high pressure hoses for kinking, cuts and leaks. If a cut or leak is found, DO NOT TOUCH HOSE AT LEAK!!! TURN UNIT OFF IMMEDIATELY! Replace hose before restarting the unit. Be sure that all damaged parts are replaced and that the mechanical problems are corrected prior to operation of the unit. If you require service, contact Mi-T-M Customer Service.
8. Trigger the gun several times and try adjusting the spray pattern. **Be certain** to LOCK the trigger gun in the "OFF" position whenever moving the adjustable or high/low nozzle, or changing quick-connect nozzles. NEVER look directly into the nozzle! High pressure water creates a risk of severe injury!
9. Do not allow unit to operate in bypass mode (with trigger closed) for more than three minutes without triggering the gun. Failure to follow this simple rule can cause premature failure of pump packing seals, resulting in costly pump repair.
10. Because your pressure washer delivers a high pressure spray and a variety of spray patterns, there are many cleaning jobs that can be done without the use of detergents.

### **shutdown:**

1. Turn engine "OFF" as directed in the Engine Manual.
2. Turn the water supply "OFF".
3. Pointing the gun in a safe direction, trigger gun momentarily to relieve any trapped pressure.
4. Once pressure is relieved, disconnect the nozzle assembly.
5. Disconnect and drain gun, wand and hoses.
6. Wipe unit clean and store with gun, wand and hoses in a safe, non-freezing area.

### **attire:**

Proper attire is essential to your safety. It is advised to utilize whatever means necessary to protect eyes, ears, and skin. Additional safety attire (such as respiratory mask) may be required when using detergent cleaning agents with this washer.



### **WARNING**

**RISK OF EXPLOSION OR FIRE!**  
ALWAYS STORE FUEL AWAY FROM THE WASHER WHILE THE UNIT IS RUNNING OR HOT.



### **CAUTION**

**RISK OF DAMAGE.**  
DONOTALLOWSPRAYPATTERN TO REMAIN ON A FIXED AREA FOR AN EXTENDED PERIOD OF TIME. POSSIBLE DAMAGE MAY OCCUR TO THE AREA.



### **CAUTION**

**RISK OF UNIT DAMAGE!**  
DO NOT OVERTIGHTEN THE UNLOADER. BREAKAGE WILL RESULT IN IMMEDIATE LOSS OF WATERPRESSUREANDCOSTLY REPAIRS.



### **DANGER**

**RISK OF INJECTION CAUSING SEVERE INJURY!**  
-KEEPCLEAROFNOZZLE!NEVER PLACE HAND OR FINGERS IN FRONT OF NOZZLE!  
-DO NOT DIRECT DISCHARGE STREAM AT PEOPLE OR PETS!  
-BE CERTAIN THE NOZZLE IS SECURELY CONNECTED TO THE WAND TO PREVENT ACCIDENTAL DISCHARGE!



### **DANGER**

**RISK OF FIRE!**  
-DO NOT SMOKE WHILE FUELING!  
-DO NOT FILL THE FUEL TANK WHILE UNIT IS RUNNING OR HOT. ALLOW UNIT & ENGINE TO COOL FOR TWO MINUTES BEFORE REFUELING.  
-DO NOT FILL FUEL TANK TO POINT OF OVERFLOWING. ALLOW APPROXIMATELY 1/4" OF TANK SPACE FOR FUEL EXPANSION.



### **WARNING**

**RISK OF ASPHYXIATION!**  
-DO NOT OPERATE IN AN ENCLOSED AREA. USE THIS PRODUCT ONLY IN WELL VENTILATED AREAS!  
-THE EXHAUST FROM THE ENGINE CONTAINS CARBON MONOXIDE, A POISONOUS, ODORLESS AND INVISIBLE GAS. BREATHING THIS GAS CAN CAUSE SERIOUS INJURY, ILLNESS & POSSIBLE DEATH.



### **DANGER**

**RISK OF EXPLOSION OR FIRE!**  
DO NOT PLACE UNIT IN AN AREA WHERE FLAMMABLE GAS VAPORS MAY BE PRESENT. A SPARK COULD CAUSE AN EXPLOSION OR FIRE!

**RISK OF UNIT BURSTING!**  
DONOTSTORE/OPERATEUNITIN A FREEZING ENVIRONMENT!



### **Attire:**

Proper attire is essential to your safety. It is advised to utilize whatever means necessary to protect eyes, ears, and skin. Additional safety attire (such as respiratory mask) may be required when using detergent cleaning agents with this washer.