



Tilematic Tile Saw

Operating Instructions



FIGURE 1

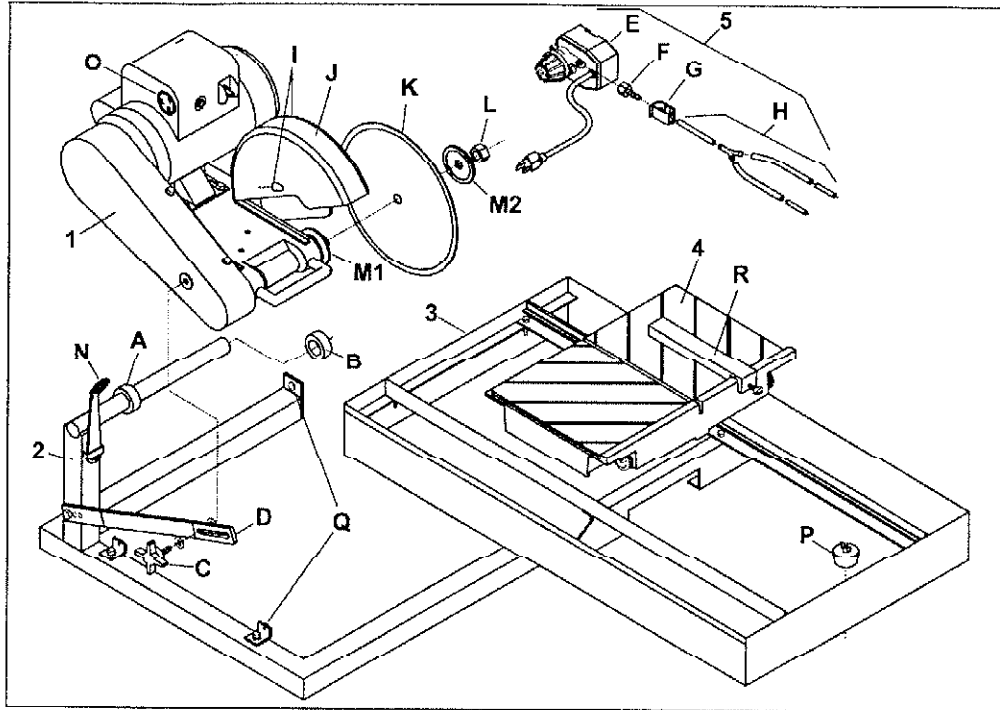

- | | |
|--|---|
| <ul style="list-style-type: none"> A. Set Collar - Fixed B. Set Collar - Loose C. Locking Knob D. Lockbar E. Water Pump F. Hose Barb G. Water Valve H. Water Tube Assembly I. Water Tube Ports J. Blade Guard K. Blade L. Blade Shaft Nut M1. Inner Blade Flange M2. Outer Blade Flange N. Wrench O. Electrical Receptacle P. Drain Plug Q. Guides R. Rip Guide | <ul style="list-style-type: none"> 1. Pivot Cutting Head Assembly: Includes water tube assembly (H)} 2. Frame Assembly 3. Water Pan Assembly 4. Conveyor Cart Assembly Carton {Cart Assembly (4) and Rip Guide (R)} 5. Water Pump and Accessory Carton: Includes Water Pump (E), Hose Barb (F), Water Valve (G), 15/16" Wrench (N), Drain Plug (P), Locking Knob (C) with 5/16" Flatwashers, and Set Collar (B). |
|--|---|

 MANDATORY  INSTRUCTION
INDICATION
INFORMATION

 WARNING  PROHIBITION

These signs will give
advice for your safety



Before leaving our factory every machine is
thoroughly tested.

Follow our instructions strictly and your machine will
give you long service in normal operating conditions.

1 Features

Use: Sawing of any kind of tile, up to 18" (457mm)
diagonal on 12" x 12" (305 x 305mm) tile.
Tools: Rip Guide comes standard on all tile saws. See
Tile Cutting Accessories on page 18.

(For information or availability of other accessories contact
your Target supplier.)

Blade Capacity: Rim Ø 10" (254mm) - bore 5/8"
(15,9mm).

Profile Wheel: Rim Ø 6" (152mm) - bore 5/8" (15,9mm).

Blade Rotation: Counter-Clockwise (CCW).

Depth of Cut: 3-3/4" (95mm) with 10" (254mm) blade.

Horsepower:	1-1/2	1-1/2	1
Voltage:	115	115/230	240
Hertz:	60	60	50
F.L. Amperages:	14.6	17.2/8.6	7.2

Blade Shaft RPM:	2760	3880	2750
Weight: lb. (kg.)	105 (48)	110 (50)	102 (46)
Dimensions - L x W x H: in (mm)	34-3/16" x 21-1/8" x 19-3/4" (861 x 537 x 502)		

Conveyor Cart - L x W: in (mm) 1-1/4" x 16 (260 x 406)

Pan Holding Capacity: 6.5 gallons (24.7 liters)

Water Pump Output: 100 gal/hr. (378 l/hr.) Standard
300 gal/hr. (1135 l/hr.) Optional



The operator must wear
protective clothing
appropriate to the work he is
doing.



Any persons not involved in the work should
leave the area.



Use only blades marked with a maximum
operating speed greater than the blade shaft
speed.



Before starting up the machine, make sure you
read this entire manual and are familiar with the
operation of this machine.



The working area must be completely clear, well
lit and all safety hazards removed.

2 Benefits

- The new, improved blade guard offers simplified blade
installation and removal - maximum 10" (254mm) blade
capacity. The external water tube assembly (H) is
removable for easy maintenance.
- 1-1/2 HP, High Torque (HT) 115V/60/1 motor on stan-
dard saw.
- The dependable, high volume, submersible coolant
pump features a screened intake.
- The motor and pump power cords are securely mounted
directly into the Motor Housing (O).
- The removable Drain Plug (P) at the back end of the
pan permits easy coolant draining and quick sludge
clean out. The Water Pan (3) is removable for easy
cleaning.
- The free-rolling Conveyor Cart (4) is aligned for straight,
smooth cuts. The Back Stop with ruler allows fast mount-
ing and adjustment of the Rip Fence (R) and optional
accessories.
- Makes diagonal cuts on 12" x 12" (305 x 305 mm)
tile. Can make 18" (460mm) rip cuts.
- Full-size belt shield and belt protection.
- The adjustable pan allows the operator to cut tile
comfortably with a full view and control of work with
minimum stretching.

3 Machine Set-Up

(See Figure 1)

- Remove all items from the shipping carton and identify:
 - Pivot Cutting Head Assembly (1): Includes Water
Tube Assembly (H)
 - Frame Assembly (2)
 - Water Pan Assembly (3)
 - Conveyor Cart Assembly Carton {Cart Assembly
(4) and Rip Guide (R)}
 - Water Pump and Accessory Carton: Includes

Water Pump (E), Hose Barb (F), Water Valve (G), 15/16" Wrench (N), Drain Plug (P), Locking Knob (C) with 5/16" flatwasher and Set Collar (B).

6. Literature Assembly Envelope

NOTE: Check the carton and all packing filler for loose parts and optional accessories (if ordered).

IF ANY PARTS ARE MISSING OR DAMAGED, PLEASE CONTACT YOUR TARGET CUSTOMER SERVICE FOR INSTRUCTIONS. CALL 1-800-288-5040

- Set the Frame Assembly (2) on a flat surface or on a TARGET® folding stand.
- Install the Water Pan Assembly (3) between the four Guides (Q) on the Frame Assembly (2). Locate the Pan with the Drain Plug (P) at the operating end with the two Stops located on the bottom of the Pan (3) straddling the front leg of the Frame. The Water Pan Assembly (3) should slide freely back and forth on the Guides (Q) with little lateral movement. Adjust if needed.

Install the Cutting Head Assembly (1):

1. Slide the Pivot Cutting Head Assembly (1) on the pivot bar up against the inner Set Collar (A). The set collar has been pre-set at the factory to align the blade with the slot in the center of the cart; it can be adjusted if needed.
2. Insert the Locking Knob (C) with 5/16" flatwasher through the slotted Lockbar (D) into the tapped hole in the belt guard. This is used to set the cutting depth of the blade.
3. Install the outer Set Collar (B) up against the other side of the Pivot Head and tighten the Set Screw.

Water Pump Assembly (5) Set-up:

1. Remove the Water Pump (E), Hose Barb (F), the Water Control Valve (G) and Water Tube Assembly (H) from their carton. Thread the Hose Barb (F) on the water pump outlet, hand tighten.
2. Slide the Control Valve (G) onto the flexible plastic tubing and push the open end onto the Hose Barb (F).
3. Set the Water Pump Assembly (5) in the deep end of the pan beneath the belt guard. **Note: The water pump inlet screen must be submerged in order to properly pick up water.**
4. Place the Water Tube Assembly (H) to the back of the Blade Guard (J) and insert the two 1/4" plastic nozzles into the two Ports (I) on the side of the Blade Guard (J). To prevent interference with the full movement of the cart, it is recommended that the tubing and electrical cord exit out the back through the indented area of the pan.
5. Insert the male plug into the Receptacle (O) on the motor. The Water Pump (E) will start when the motor is turned on. For dry cutting, the water pump should be unplugged or removed to prevent damage to the pump.

NOTE: THE MOTOR WATER PUMP OUTLET IS NOT TO BE USED AS A GENERAL PURPOSE CONVENIENCE OUTLET. USE FOR CONNECTION OF THE SUPPLIED WATER PUMP ONLY.

WATER PUMP SAFETY GUIDELINES



Always plug the saw power cord into a GFCI outlet when using. If a GFCI type outlet is not available, use a plug-in type GFCI plugged into a properly grounded outlet. Do not use any temporary plug adapters.

- The water pump is equipped with a ground electrical plug, to reduce the risk of possible shock. Be sure to connect to a properly grounded type receptacle.
- Never pick the water pump up out of the water when it is plugged in.
- **DO NOT EVER** use the water pump to pump anything but water.
- Never service the pump when it is still plugged in.
- Never let the pump operate dry. It is self-cooled by pumping water. Dry use will cause the pump to fail.
- Maintain regularly and clean out debris from intake screen.
- Check the power cord for nicks or frays and never try to alter the power cord in any way.

Install the Cutting Blade:



Always set the Motor Switch to OFF prior to mounting the blade.

1. Be sure you are using the correct blade for the material being cut. For example, blades are available for cutting materials such as wall tile, quarry tile, marble, slate and similarly hard materials. For the best results, always use genuine TARGET® diamond blades. Contact your nearest dealer to select the correct blade for your specific cutting needs.
2. Rotate the Blade Guard (J) fully up, tightening the wing nut if needed to hold it in the fully raised position.
3. Remove the Blade Shaft Nut (L) and the Outer Blade Flange (M2).
4. Check the blade for Counter Clockwise rotation (CCW) and install on the spindle shaft.





Rotation direction is indicated by an arrow on one side of the blade. Make sure the blade contact surfaces are clean.

5. Install the Outer Flange (M2) with the large diameter against the Blade (K). Tighten the Blade Shaft Nut (L) with the 15/16" Wrench (N) provided.
6. Lower the Blade Guard (J) and retighten the wing nut to securely hold the guard in place.

- Install the Drain Plug (P) into the front end of the pan and fill with clean water until inlet filter of water pump is covered; about 6.5 gal. (25 l).
- Adjust the Pan Assembly (3) to accommodate the size of the tile to be cut and to obtain the most comfortable position for the operator.
 1. When cutting smaller tile units, adjust the pan all the way to the rear. The operator has full view and control of the work with minimum stretching.
 2. For cutting intermediate sized units, such as 8" or 10" tile, the pan can be placed somewhere between the maximum forward and maximum rear positions.
 3. When cutting larger units, the pan should be moved to the maximum forward position, thus giving the operator the best and most comfortable position, even when cutting 12" x 12" or larger units.

4 OPERATING PROCEDURE

 **WARNING: Read the Operating Procedure completely before operating your tile saw.**

 **Take into account the working conditions from the health and safety point of view.**

 **Always pay extreme care and attention to the preparation of the machine before starting.**

 **Remove all wrenches and tools from the machine.**

 **Always keeps blade guard in place.**

- Fill the Pan (3) with enough water to fully submerge the water pump screen. It takes approximately 6-1/2 gallons (25 l) to fill the Pan.
- Before connecting the power cord:
 - * Check the Blade Shaft Nut (L) to be sure it is tight and that the Blade (K) rotates freely.

 **WARNING: Check that the ON/OFF switch is in the OFF position. Then connect the power cord to a properly grounded outlet of the correct voltage. See the decal near the power cord for power requirements. If needed, use the correct size three (3) conductor extension cord to avoid excessive voltage drop. Never use lamp cord type extensions. Refer to the Recommended Extension Cords chart below.**

- Turn the switch to ON. The blade should turn counter-clockwise, when looking at the blade guard side. The water pump will start automatically when the motor starts. Adjustment of the water supply may be made by means of the Control Valve(G).
- Follow the blade manufacturer's recommendations for dry or wet cutting. Wet cutting blades can be damaged or destroyed without sufficient water. Only blades specifically designed for dry cutting can be used without coolant.



The water supply should be adequate, with water flowing on both sides of the blade. Keep the water clean and make certain the WATER LEVER IS ALWAYS ABOVE THE PUMP INLET. Do not run the water pump dry!! Unplug for dry cutting.

- For straight cuts, position the tile squarely against the back edge of the conveyor cart. Keep the cart clean and free of cuttings. The standard Rip Guide (R) is used.
- Move the conveyor cart slowly and carefully until the blade is in contact with the tile. The blade needs a chance to "break-in" or "wear-in" slightly. It may take about ten cuts to open a new blade for best cutting.

5 ADJUSTABLE LOCKBAR WITH DEPTH LINKING PROTECTION

See Figure 2

A Lockbar (28) is used to set the blade depth during cutting. The lockbar has three (3) holes at the lower end marked 10, 8 and 6. These are used as depth-limiting settings that, if used with the correct blade diameter, will protect the rolling cart from being cut by the blade. The three (3) holes in Lockbar:

- 10 - The lowest hole is for use with a 10" diameter blade.
- 8 - The middle hole is for use with an 8" diameter blade.
- 6 - The uppermost hole is for use with a 6" diameter blade or profile wheel.

The Tilematic is shipped standard set-up for a 10" diameter blade. To change the setting, locate the capscrew (29) used as the pivot, loosen and remove the Lock Nut (31). Set the Lockbar (28) at the proper hole. Tighten the fasteners so that the Lockbar (28) is free to pivot. Check the setting by loosening the Knob (32) and lowering the head fully down into the table slot. The blade segment should be below the table surface, but not cutting into the table.

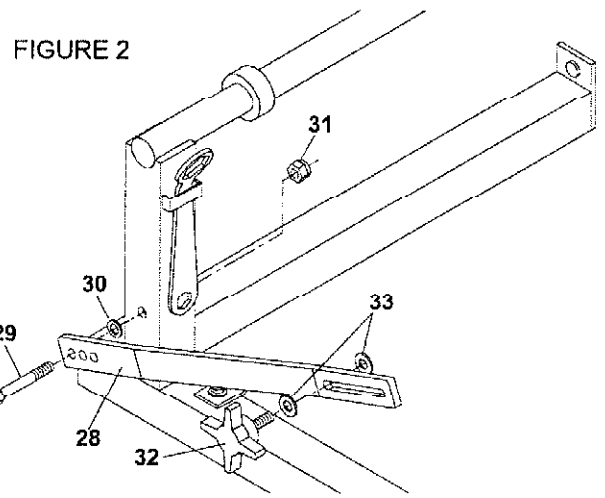

6 MANUAL THERMAL OVERLOAD

The motor is equipped with a manual overload protection reset button. If the motor overheats, the red reset button will "pop out" to open the motor circuit; stopping the motor and water pump. If this occurs, the motor ON/OFF switch must be set to OFF. After the motor cools, push in the reset button. When it stays in, the motor can be restarted.

7 RECOMMENDED EXTENSION CORDS



Good motor performance depends on proper voltage. Extension cords that are too long and/or too small in wire gauge reduce the voltage to the motor under load. Use extension cords no smaller than indicated below.

MOTOR HP RPM	F.L. AMPS		50' Cord		75' Cord		100' Cord	
	115V	230V	115V	230V	115V	230V	115V	230V
230V								
1-1/2 1725	14.6		#12		#10		#8	
1-1/2 3450	17.2	8.6	#10	#14	#10	#14	#8	#14
1 1425	7.2		#14		#14		#14	

8 ALIGNMENT PROCEDURES

Your **Tilematic** tile saw is factory assembled and aligned prior to shipment to ensure accurate cuts when your saw is delivered. However, since **TARGET®** cannot control rough handling during shipping, it is suggested that the alignment be checked. If the saw is found in need of adjustment, refer to the appropriate section(s) below.

There are two basic alignment checks for the **Tilematic** and any adjustments made must follow these procedures to ensure that the unit functions freely.

Adjustment tools required: Carpenter's Square, two (2) 7/16" wrenches, and 5/32" hex key.

1. Check the Blade in Slot Alignment

- * The Blade (K) should be centered in the Conveyor Cart (4) slot.
- * Set-up your saw as described above and move the Conveyor Cart (4) back and forth from the front to the rear of the Pan (3). If the Blade (K) contacts either side of the slot, the Cutting Head Location Adjustment must be performed.

Cutting Head Location Adjustment (See Figs 1 & 3)

- * The Pivot Cutting Head Assembly (1) is located between the Set Collars (A-B). Using a 5/32" hex key, loosen both Set Collars. Move the Head Assembly (1) along the Pivot Bar (S) until the Blade (K) no longer contacts the slot. Re-locate the Set Collars against the sides of the Pivot Cutting Head again and retighten the screws.

FIGURE 3

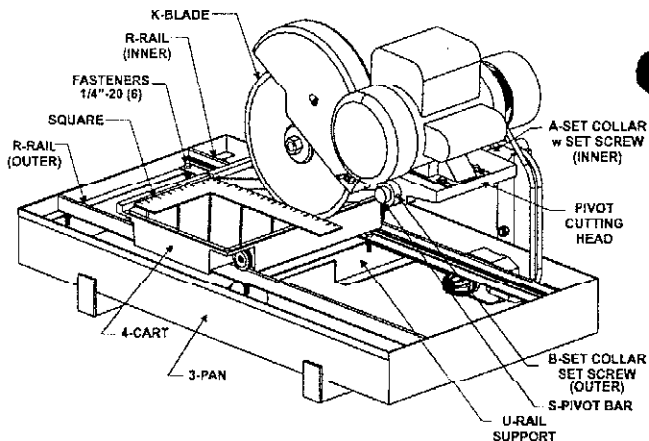

2. Check the Parallel Alignment (See Figure 3)

- * The Conveyor Cart (4) should travel parallel to the plane of the Blade (K).
- * Place a Square rule against the backstop, lightly in contact with the Blade (K). The blade surface should be parallel to the square; i.e., no gap between the blade and the square at either the front or back edge of the blade. Next, holding the square firmly, traverse the cart fore and aft. The blade should remain parallel to the square, staying slightly in contact with it throughout its full travel. If the blade does not stay in contact with the square, the Parallel alignment must be performed.

Parallel Alignment

- * The parallel tracking of the cart can be adjusted by moving the rails on which the cart travels. The mounting holes in the pan are slotted to accommodate this adjustment.
- * Align the Inner Rail first. Loosen the four (6) 1/4"-20 fasteners (7/16" wrenches) locating the two (2) Rails (R) so that both rails are free to move. Move the end(s) of rail until the square is flush with the blade as described above. Tighten the fasteners of this rail and recheck the alignment. Once alignment has been made, move the cart fore and aft to locate the second rail parallel to the first. Tighten the remaining two fasteners.

9 PROFILE WHEEL SET-UP AND USE

See Figure 1

The **Tilematic** is designed for use with a **TARGET®** 6" Profile Wheel, such as P/N 621081 or 621082.

- Raise the blade guard. Remove the spindle nut and outer flange. Remove the tile saw blade if one has been installed. (Refer to Section 5, Adjustable Lockbar, if needed)
- Install the profile wheel onto the spindle shaft up against the inner flange with the working surface to the outside.
- Secure into place by reversing the outer flange and tightening the spindle nut. Lower the Blade Guard (J) back down over the profile wheel.

- Locate the material for profiling:
 1. Set the edge of the part to be shaped parallel to the wheel.
 2. Locate the material under the wheel. Pull the Conveyor Cart (4) with the material from under the wheel to set proper cutting height.
 3. Loosen the Locking Knob (C) and lower the Cutting Head (1) so that the wheel just slightly makes contact with the material.
 4. Secure the Cutting Head (1) into position with the Locking Knob (C) for cutting.
 5. **Note:** Profiling usually takes several light passes to produce the best results. Set lower each time until the desire depth has been reached.

10 MAINTENANCE PROCEDURES



Before performing any maintenance, ALWAYS place the machine on a level surface with the motor OFF and disconnect the electrical current. Let the machine cool down!!

Your TRAGET® tile saw is a ruggedly constructed machine, engineered to give long, satisfactory performance. Simple daily maintenance and care will add to the life and productivity of your saw. After each day's use: **CLEAN THE MACHINE!!**

- * Turn off and unplug the saw before performing any maintenance.
- * Keep the cart top clean and free for cuttings. To clean it, flush the top surface and grooves with water.
- * Drain, clean and refill the pan frequently. Flush the coolant system with plenty of water, then drain and refill the pan.
- * If the water flow stops, check the water pump to see if the shaft and impeller turn freely. See the **WATER PUMP TROUBLE-SHOOTING PROCEDURE** section.
- * It is always good practice to clean your tile saw after each day's use. Drain the water and clean out the pan. Clean the rails. Before storing, it is good practice to wipe or spray rails with water-soluble oil (like, WD-40 or equivalent).



Entrust all repairs to your authorized dealer only.

11 WATER PUMP TROUBLE-SHOOTING PROCEDURE

If Water Stops Flowing,

1. Stop Sawing, then
2. Disconnect Electrical Plug from Outlet, then
3. Remove the Pump, then
4. Back Flush.

Back flushing is done by forcing water into the pump discharge and out through the screen. Most of the time this procedure works, and the pump can be put back into service. (See Figure below)

If the back flushing does not work, remove the screen and turn the impeller manually, looking for and rinsing out the impeller cavity of any dirt or foreign matter.

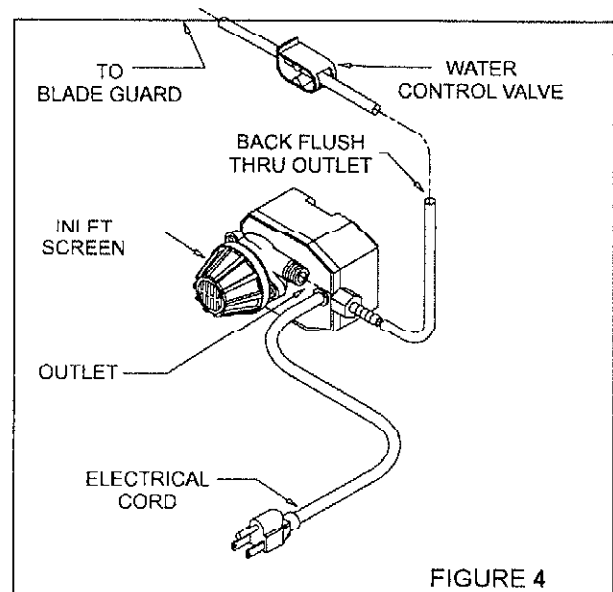

FIGURE 4

12 REPAIRS

We carry out all repairs in the shortest possible time and at the most economical prices. (See front page for address and phone numbers) Contact your authorized TARGET® dealer concerning maintenance and repairs.

13 SPARE PARTS

For quick supply of spare parts and to avoid any lost time, it is essential to quote the data on the manufacturers plate fixed to the machine and the part number(s) and description to be replaced with every order.